



“... what my God had put  
in my heart to do . . .”  
**Nehemiah 2:12**

# TEMPLE BAPTIST SEMINARY

Birkhead Building

Spring 2007

## “*Building Initiative*”

*INVITING Your Initiative*

“...rebuilding (the) Temple...”

Ezra 9:9; Neh. 4:18

2 Cor. 8:3-5

### *Missions Center Campaign*

#### **Start Up for Mission Center**

The following items are the basic essentials we need to get the mission center up and running. We have many more things on our wish; however, we must have the following items so we can get started.

#### **Offices**



- \_\_\_\_\_ 1) Materials for office – labor donated .....1,300.00
- \_\_\_\_\_ 2) 4 bookshelves\* .....1,200.00
- \_\_\_\_\_ 3) 2 file cabinets\* (\$250)

#### **Interactive Area**



- \_\_\_\_\_ 1) Room divider screen panels.....1,500.00
- \_\_\_\_\_ 2) Wood for benches in church.....250.00
- \_\_\_\_\_ 3) Materials to make church walls .....250.00



- \_\_\_\_\_ 5) 4 adjustable tables\* (\$450)
- \_\_\_\_\_ 6) Screen divider .....100.00

#### **Welcome Area**



- \_\_\_\_\_ 1) 13 x 8 foot map .....200.00

Sheetrock to mount map on\*



#### **Prayer Area**

- \_\_\_\_\_ 1) 2 large bulletin boards .....400.00

\_\_\_\_\_ \*\*\* **Total** .....**5,200.00**

***Missions Center***  
**Layout Diagram**

**Rm. 212 – Birkhead Building**

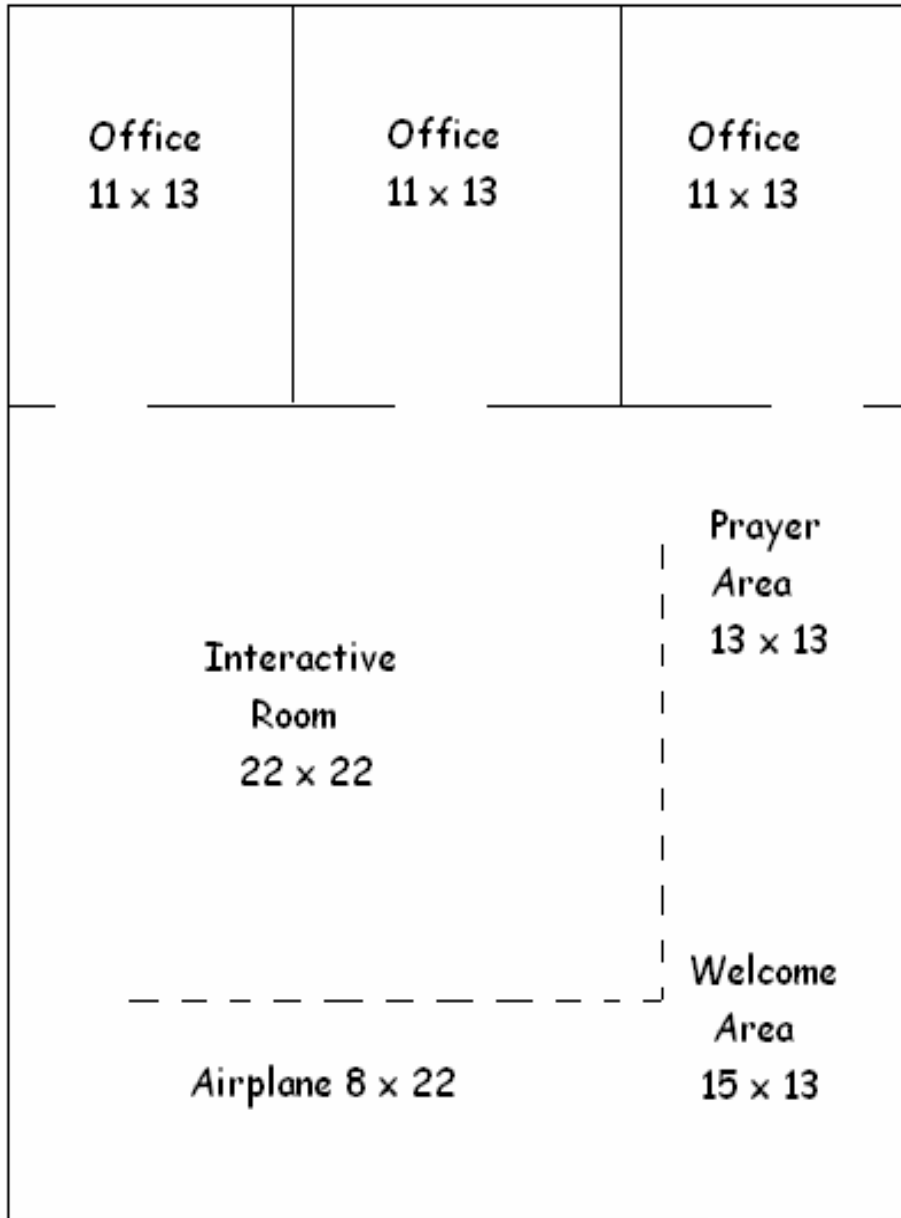

Dashed line - portable partition system

[Continued on the Next Page]

**TEMPLE BAPTIST SEMINARY – “BUILDING Initiative”**

**Needed to Complete the Mission Center**

	_____ 1.) “Wonder World”.....	\$200
	_____ 2.) World Rug .....	\$400
	_____ 3.) Interactive prayer case .....	\$855
	_____ 4.) Jeopardy system.....	\$495
	_____ 5.) Display case 1 .....	\$899
	_____ 6.) Display case 2.....	\$1199
	_____ 7.) Shelving for resource room .....	\$1200
	_____ 8.) Outside sign .....	\$238
	_____ 9.) Reception center .....	\$1779
	_____ 10.) Prayer room credenza .....	\$819
	_____ 11.) Prayer room credenza hutch .....	\$419
	_____ 12.) Great Commission Airlines counter (lectern).....	\$289
	_____ 13.) Chairs for airplane (32 @ \$68).....	\$2176
	_____ 14.) Computer (need 20).....	\$2000
	_____ 15.) Computer projector.....	\$3,000
	_____ 16.) Computer projector screen.....	\$250
	_____ 17.) Television for the airplane.....	\$800
	_____ <b>*** Total for all projects .....</b>	<b>\$17,018</b>
	_____ <b>*** Total Missions Center costs.....</b>	<b>\$22,218</b>